

# Homogenizer HST - HLE22

- Standard capacity 13 gal/min
- Standard homogenizer pressure 2,901 PSI
- Absorbed motor power: 30 hp
- Aseptic execution is optional
- Sustainable for processing high viscosity products
- Unique design in accordance with the conditions of use simple installation, economic design, and easy maintenance

Weight with motor: Approx. 2,425 lbs  
 Technical changes reserved!



Model	Max. Capacity	Max. Pressure
HST-HLE22	GPM	PSI
HLE22-120	22	1,740
HLE22-170	18	2,466
HLE22-200	13	2,901
HLE22-250	11	3,626
HLE22-300	9	4,351
HLE22-400	7	5,802
HLE22-500	4	7,252
HLE22-600	3	8,702
HLE22-750	2	10,878
HLE22-1000	1	14,504

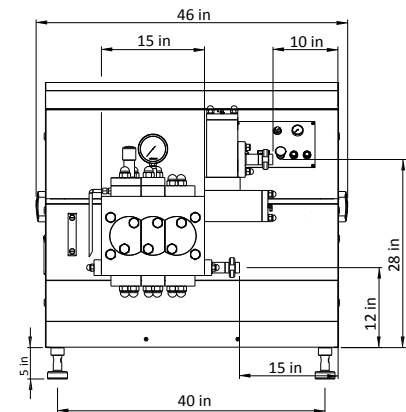

Model	Max. Speed	Max. Diameter
HST-HLE22	RPM (Speed)	MM (Diameter)
HLE22-120	163	55
HLE22-170	163	50
HLE22-200	170	45
HLE22-250	145	45
HLE22-300	128	40
HLE22-400	128	35
HLE22-500	122	30
HLE22-600	122	25
HLE22-750	122	20
HLE22-1000	122	16

